

DRAWING No. 016512

ISSUE	CHANGE	DATE	CHK.
A		08.09	
B		01.12	FS

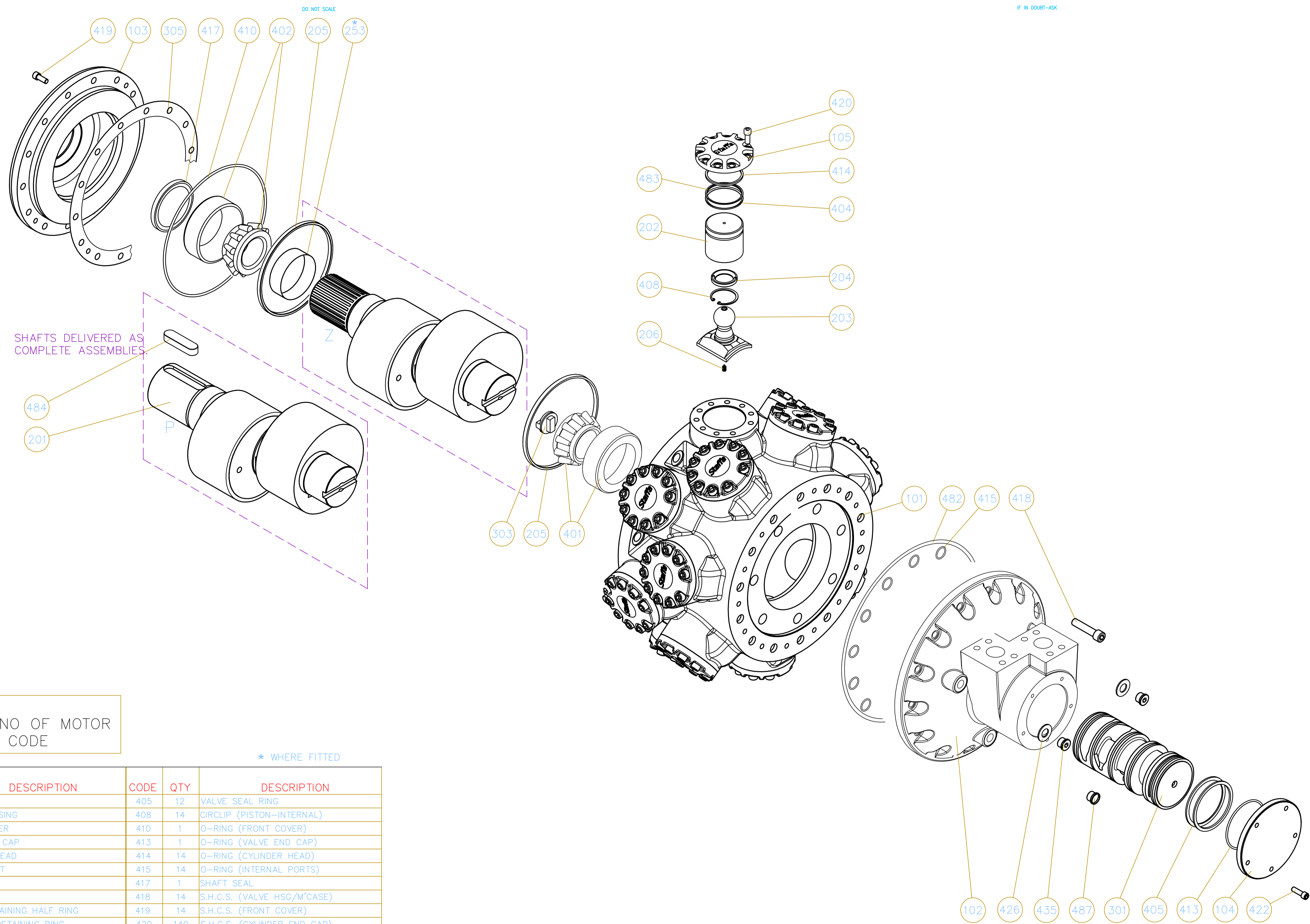

SPARES :
QUOTE SERIAL NO OF MOTOR
+ FULL MODEL CODE

* WHERE FITTED

CODE	QTY	DESCRIPTION	CODE	QTY	DESCRIPTION
101	1	MOTORCASE	405	12	VALVE SEAL RING
102	1	VALVE HOUSING	408	14	CIRCLIP (PISTON-INTERNAL)
103	1	FRONT COVER	410	1	O-RING (FRONT COVER)
104	1	VALVE END CAP	413	1	O-RING (VALVE END CAP)
105	14	CYLINDER HEAD	414	14	O-RING (CYLINDER HEAD)
201	1	CRANKSHAFT	415	14	O-RING (INTERNAL PORTS)
202	14	PISTON	417	1	SHAFT SEAL
203	14	CON-ROD	418	14	S.H.C.S. (VALVE HSG/M*CASE)
204	28	PISTON RETAINING HALF RING	419	14	S.H.C.S. (FRONT COVER)
205	4	CON-ROD RETAINING RING	420	140	S.H.C.S. (CYLINDER END CAP)
206	14	RESTRICTOR SCREW	422	5	S.H.C.S. (VALVE END CAP)
253 *	1	SHAFT SLEEVE	426	2	BONDED SEAL
301	1	VALVE SPOOL	435	2	DRAIN PLUG
303	1	OLDHAMS COUPLING	482	1	O-RING (VALVE HOUSING SURROUND)
305	-	SHIM (STEEL)	483	14	PISTON SEAL BACKING RING
401	1	REAR BEARING	484	1	CUSTOMER KEY
402	1	FRONT BEARING	487	1	PLASTIC PLUG
404	14	PISTON SEAL RING			

THIRD ANGLE PROJECTION 	NAME	DATE	KPM Kawasaki Precision Machinery Staffa Products	Ernesettle, Plymouth PL5 2QA www.kpm-eu.com					
	DR: M.NORMAN	28.08.09							
	CHK:		TITLE	GENERAL ASSEMBLY (FOR SPARES) HMB700 MOTOR					
	ENGR: APPL:		SIZE	A1	SCALE	NTS	DRAWING No.	016512	SHEET
WT:		ALL TECHNICAL DATA DISCLOSED HEREIN IS THE PROPERTY OF KAWASAKI AND SHALL NOT BE USED BY OTHERS FOR MANUFACTURE, PROCUREMENT OR DISCLOSURE WITHOUT THE WRITTEN PERMISSION OF THE OWNER.							