

DRAWING No. 016502			
ISSUE	CHANGE	DATE	CHK.
A		05.09	FS

DO NOT SCALE

IF IN DOUBT-ASK

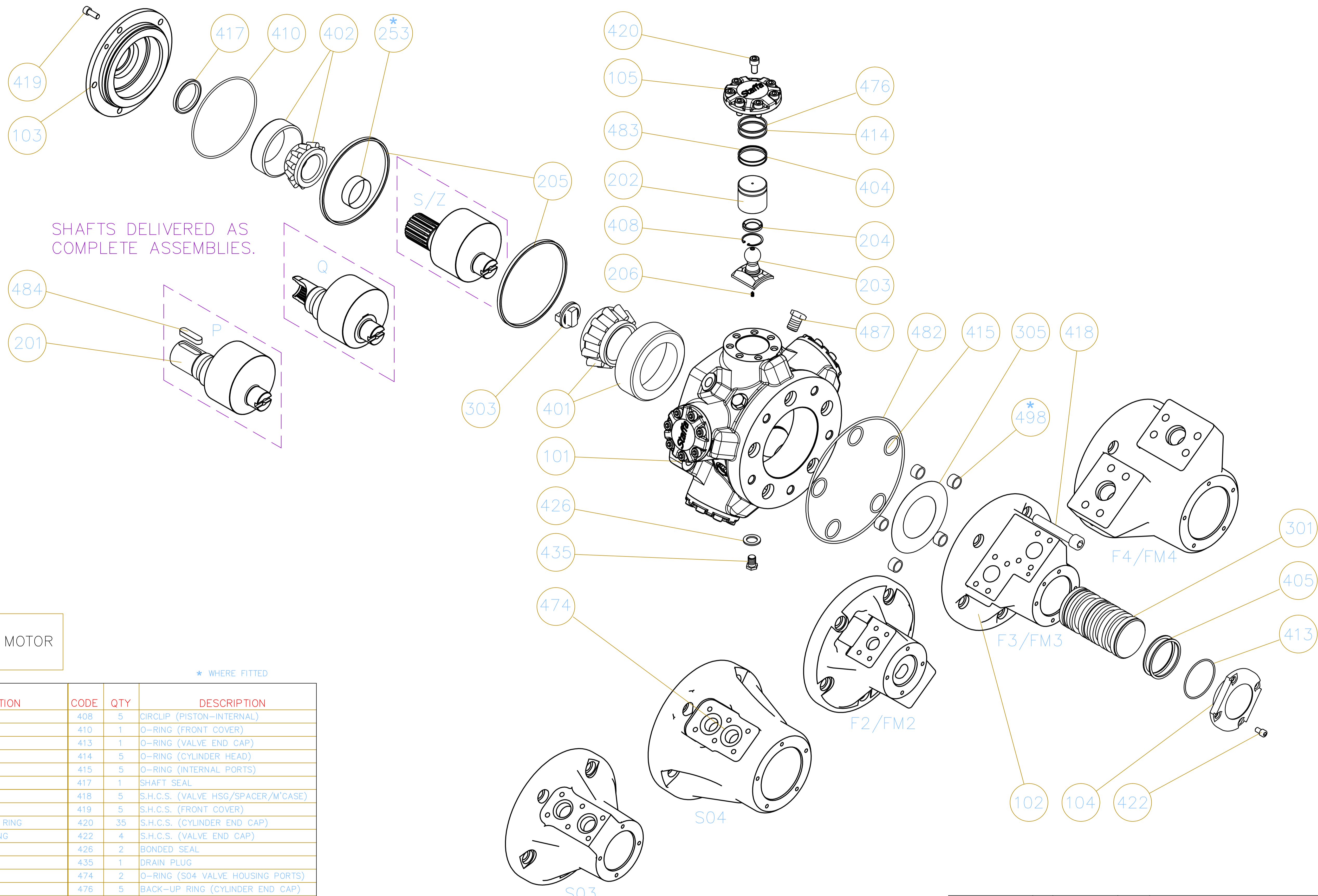

SPARES :
QUOTE SERIAL NO OF MOTOR
+ FULL MODEL CODE

* WHERE FITTED

CODE	QTY	DESCRIPTION	CODE	QTY	DESCRIPTION
101	1	MOTORCASE	408	5	CIRCLIP (PISTON-INTERNAL)
102	1	VALVE HOUSING	410	1	O-RING (FRONT COVER)
103	1	FRONT COVER	413	1	O-RING (VALVE END CAP)
104	1	VALVE END CAP	414	5	O-RING (CYLINDER HEAD)
105	5	CYLINDER HEAD	415	5	O-RING (INTERNAL PORTS)
201	1	CRANKSHAFT	417	1	SHAFT SEAL
202	5	PISTON	418	5	S.H.C.S. (VALVE HSG/SPACER/M'CASE)
203	5	CON-ROD	419	5	S.H.C.S. (FRONT COVER)
204	10	PISTON RETAINING HALF RING	420	35	S.H.C.S. (CYLINDER END CAP)
205	2	CON-ROD RETAINING RING	422	4	S.H.C.S. (VALVE END CAP)
206	5	RESTRICTOR SCREW	426	2	BONDED SEAL
253 *	1	SHAFT SLEEVE	435	1	DRAIN PLUG
301	1	VALVE SPOOL	474	2	O-RING (S04 VALVE HOUSING PORTS)
303	1	OLDHAMS COUPLING	476	5	BACK-UP RING (CYLINDER END CAP)
305	-	SHIM (STEEL)	482	1	O-RING (VALVE HOUSING SURROUND)
401	1	REAR BEARING	483	5	PISTON SEAL BACKING RING
402	1	FRONT BEARING	484	1	CUSTOMER KEY
404	5	PISTON SEAL RING	487 *	1	PLASTIC PLUG
405	12	VALVE SEAL RING	498	5	O-RING RETAINER (LONG)

THIRD ANGLE PROJECTION 	NAME	DATE	KPM Kawasaki Precision Machinery Staffa Products	Ernesettle, Plymouth PL5 2QA www.kpm-eu.com
	DR: M.NORMAN	20.05.09		
	CHK: FSTANTON	01.09	TITLE: GENERAL ASSEMBLY (FOR SPARES)	
	ENGR: APPL: FSTANTON	01.09	HMB030/045 2 PT MOTOR	
ALL TECHNICAL DATA DISCLOSED HEREIN IS THE PROPERTY OF KAWASAKI AND SHALL NOT BE USED BY OTHERS FOR MANUFACTURE, PROCUREMENT OR DISCLOSURE WITHOUT THE WRITTEN PERMISSION OF THE OWNER.			SIZE: A1	SCALE: NTS
			DRAWING No. 016502	SHEET 1 of 1